

TRIPOD PARTS ASSEMBLY

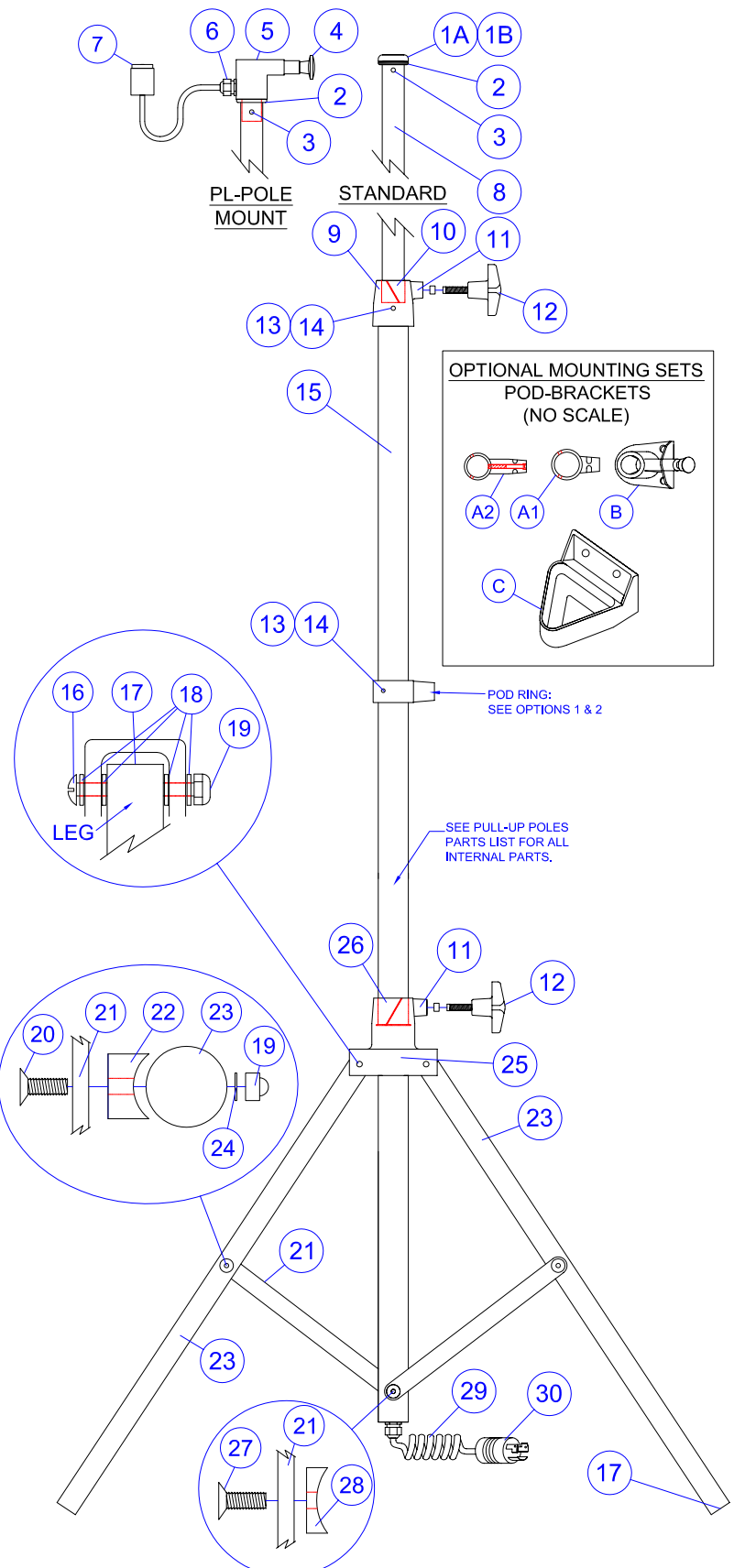

PARTS LIST			
NO.	PART NO.	DESCRIPTION	QTY.
1A	101-TB	1/2" TOP BUSHING *	1
1B	103-TB	3/4" TOP BUSHING **	1
2	120-OR	O-RING SEAL	1
3	124-SS	1/4-20 x 1/4 SETSCREW	2
4	220-SPA	SPRING PIN ASSEMBLY	1
5	212-PMA	PORTABLE LIGHT MOUNT	1
6	127-SR	1/2" STRAIN RELIEF	1
7	213-CN	L5-15 CONNECTOR****	1
8	EP-125	1.25" INSIDE POLE***	1
9	LC	LOCK COLLAR INCLUDES	1
10	126-NS	109-LC NYLON SLEEVE	1
11	123-SP	LOCKING PUCK	1
12	120-KB	LOCKING COLLAR KNOB	2
13	125-SS	1/4-20 x 5/16 SETSCREW	2-3
14	128-SS	1/4-20 x 1/4 COIL INSERT	2-3
15	EP-171	1.71" OUTER POLE***	1
16	310-MS	1/4-20 x 2 1/2 SCREW	3
17	171-BS	1 1/4 UNIVERSAL PLUG	6
18	315-WA	1/2" OD x 0.062 WASHER	12
19	314-LN	1/4-20 NYLOC NUT	6
20	311-BT	1/4-20 x 2 1/4 BOLT	3
21	317-SA	TRIPOD SUPPORT ARM	3
22	125-CS	1.71" POLE SADDLE	3
23	EP-125	1.25" TRIPOD LEG***	3
24	316-WA	1/2" OD x 0.030 WASHER	3
25	TLC	LOCKING COLLAR INCLUDES	1
26	127-NS	309-TLC NYLON SLEEVE	1
27	312-SC	1/4-20 x 3/4 SCREW	3
28	125-CJ	TRIPOD LEG SADDLE	3
29	480-CC	48" COIL CORD	1
30	203-PG	L5-15 PLUG - STD.****	1

OPTION 1: POD-BRACKET STANDARD			
A1	340-PR	STANDARD POD RING	1
B	PLMT	MOUNTING BRACKET	1
C	341-FB	TRIPOD FOOT BRACKET	1

OPTION 2: POD-BK-LONG			
A2	314-TPB	3" TAPERED POD RING	1
B	PLMT	MOUNTING BRACKET	1
C	341-FB	TRIPOD FOOT BRACKET	1

NOTES:
 * 101-TB IS USED IF LIGHT HEAD IS A NORTH STAR LIGHT; FOR DAYMAKERS, A MODIFIED VERSION, 101-TBDM, IS USED.
 ** 103-TB IS USED IF LIGHT HEAD IS A STONCO LIGHT
 *** POLE LENGTHS VARY WITH EACH OF THE THREE (3) MODELS.
 **** NEMA CONNECTOR AT REQUIRED BY CUSTOMER
 STANDARD STOWED HEIGHT IS 72". MEDIUM STOWED HEIGHT OF 55" AND SMALL STOWED HEIGHT OF 43" ARE ALSO AVAILABLE.