

8 7 6 5 4 3 2 1

THIS DRAWING AND ALL INFORMATION CONTAINED HEREIN IS THE PROPERTY OF WELDON TECHNOLOGIES, INC. AND MAY NOT BE COPIED, REPRODUCED, OR DEVLGED TO UNAUTHORIZED PERSONS WITHOUT THE EXPRESS WRITTEN CONSENT OF WELDON TECHNOLOGIES, INC. AS IT IS BEING PROVIDED SOLELY FOR THE CONVENIENCE OF THE USER AND SHALL BE RETURNED TO WELDON TECHNOLOGIES, INC UPON REQUEST.

CAUTION - THIS IS A HIGH VOLTAGE DEVICE. DO NOT OPERATE IF THERE IS VISIBLE DAMAGE TO BALLAST, HID BULB, OR CABLE.

REVISIONS					
REV.	ECN	DESCRIPTION	DATE	BY	APVD
A	R0432	DOCUMENTATION RELEASE	3/16/04	TS	ST
B	0662	PLUG PART NUMBER WAS 0L40-1473-00	1/2/06	TB	ST

- NOTES:
- FOR PROPER OPTICAL PERFORMANCE, LAMP MUST BE MOUNTED ACCORDING TO THE "TOP" MARKING ON LENS.
 - DIMENSIONS SHOWN ARE FOR REFERENCE ONLY.
 - MOUNT BALLAST USING ADHESIVE BACKED, RECLOSEABLE FASTENER SUPPLIED WITH LAMP.
 - CARE MUST BE TAKEN TO SUPPORT LEAD WIRES. DO NOT RELY ON LAMP OR BALLAST CONNECTIONS TO SUPPORT WEIGHT OF HARNESSING. DAMAGE TO CABLES OR CONNECTORS WILL VOID WARRANTY.
 - BACK OF LAMP TO BE PROTECTED FROM DIRECT SPRAY, ROAD/TIRE WASH, OR OTHER DIRECT ENVIRONMENTAL EXPOSURE.
 - SPACER CAN BE REMOVED FROM LAMP ASSEMBLY IF SUFFICIENT MOUNTING DEPTH IS AVAILABLE. USE WTI FOAM GASKET P/N 0D10-1025-00 TO SEAL LAMP TO BEZEL.
 - DO NOT USE ABRASIVE TOOLS OR CLEANERS ON LENS SURFACE.
 - DO NOT EXCEED 15 IN-LBS OF MOUNTING TORQUE ON BEZEL OR LENS SCREWS.

- ELECTRICAL:
- RED WIRE IS POSITIVE DC VOLTAGE, WHITE WIRE IS GROUND.
 - OPERATING VOLTAGE RANGE IS 10-16VDC.
 - NOMINAL POWER: 35W

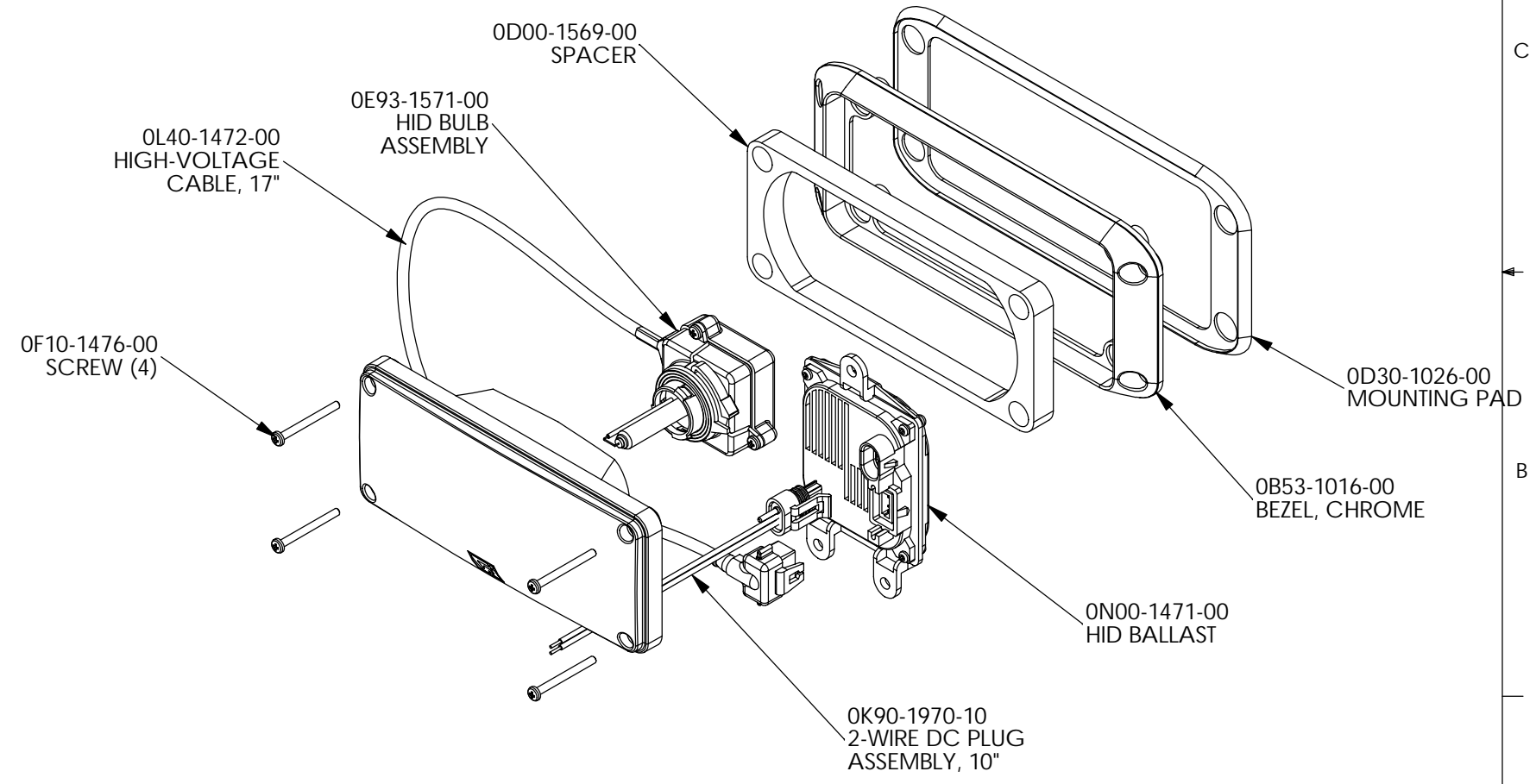
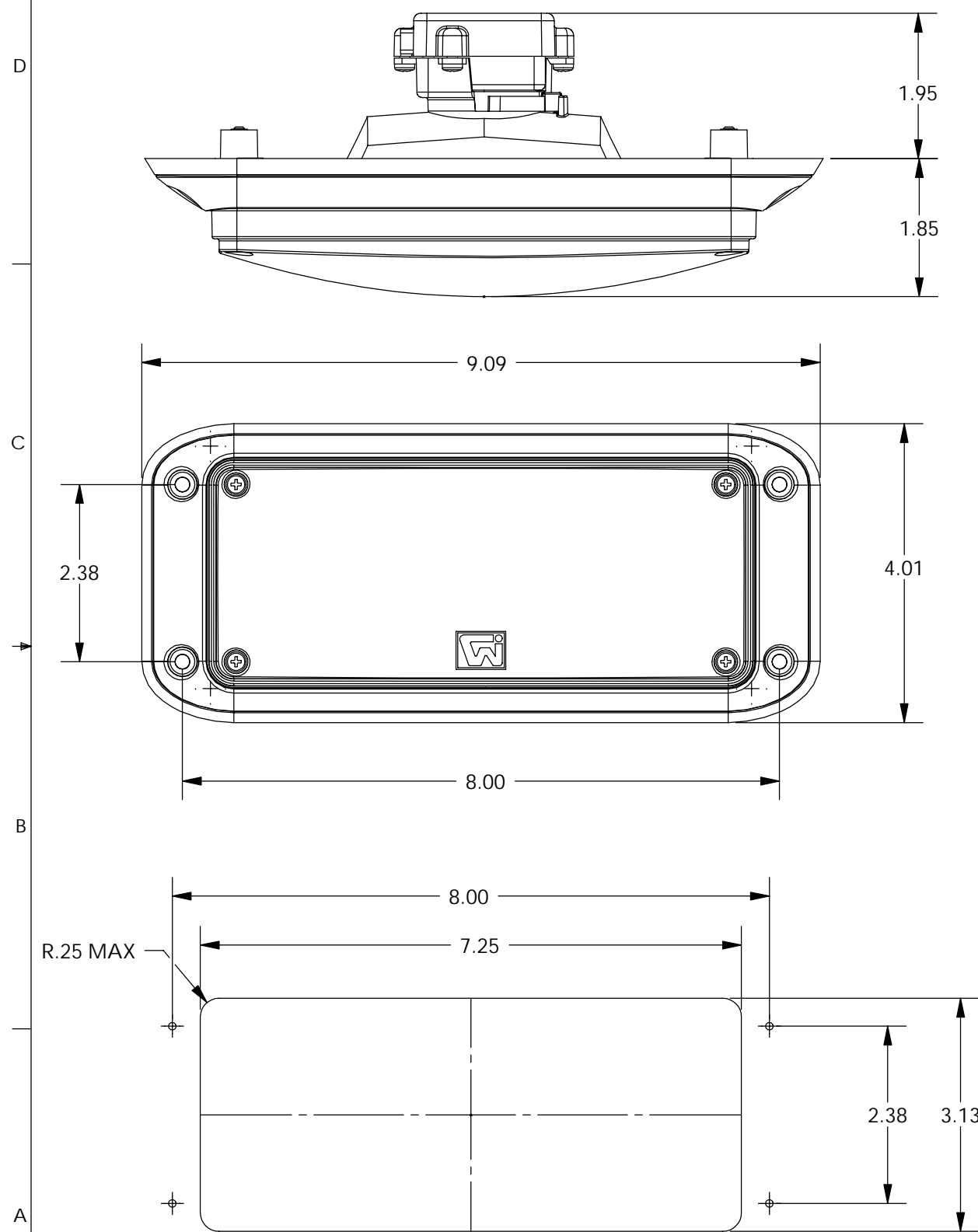

UNLESS OTHERWISE SPECIFIED DIMENSIONS ARE IN INCHES TOLERANCES ARE:		CAD GENERATED DRAWING, DO NOT MANUALLY UPDATE		WELDON TECHNOLOGIES, INC.	
X.XXX - ±0.005		APPROVALS	DATE	CUSTOMER DRAWING HID SCENE, BEZEL MOUNT 3800 SERIES	
X.XX - ±0.020		DRAWN	TS 2/25/04		
X.X - ±0.050		CHECKED	ST 2/25/04		
ANGLES - ±0.5°		QUAL ENG			
MATERIAL		MFG ENG		SIZE	PART NO.
FINISH		DO NOT SCALE DRAWING	PROJ. NO.	B	C3862-0000-33
				SCALE:	1:2
				WELDON COMPUTER GRAPHICS SHEET 1 OF 1	

8 7 6 5 4 3 2 1