

THIS DRAWING AND ALL INFORMATION CONTAINED HEREIN IS THE PROPERTY OF WELDON TECHNOLOGIES, INC. AND MAY NOT BE COPIED, REPRODUCED, OR DIVULGED TO UNAUTHORIZED PERSONS WITHOUT THE EXPRESS WRITTEN CONSENT OF WELDON TECHNOLOGIES, INC. AS IT IS BEING PROVIDED SOLELY FOR THE CONVENIENCE OF THE USER AND SHALL BE RETURNED TO WELDON TECHNOLOGIES, INC UPON REQUEST.

REVISIONS				
REV.	ECN	DESCRIPTION	DATE	BY APVD
A	R0694	DOCUMENTATION RELEASE	7/5/06	TS ST

LENS SCREW  
TIGHTENING TORQUE  
8-12 in/lbs

CLEARANCE FOR  
#10 SCREW (MAX.)  
(4 PLCS.)  
INSTALLATION TORQUE  
18 in/lbs (MAX.)

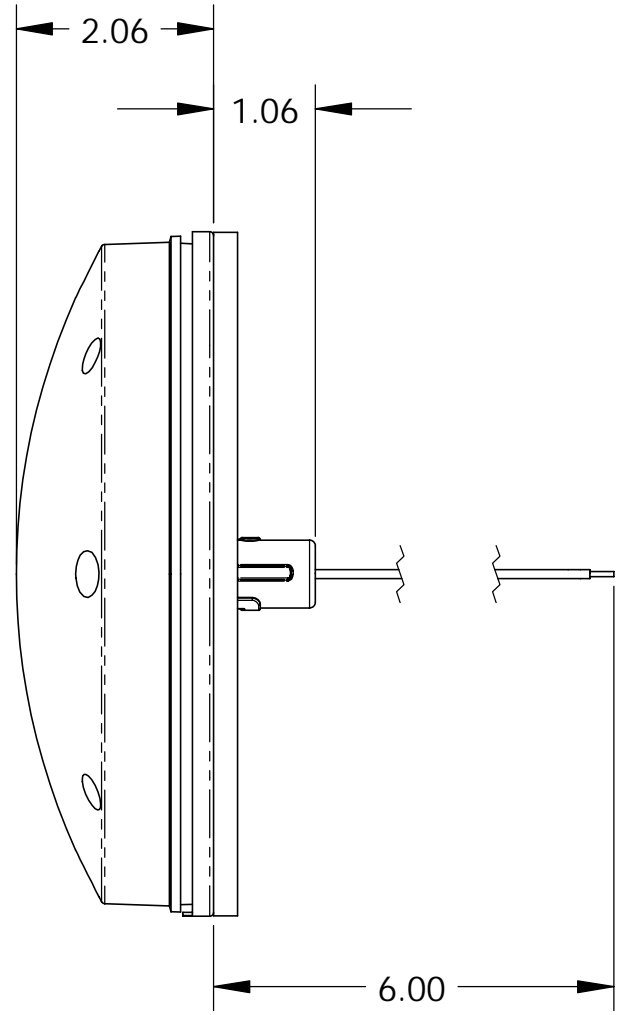
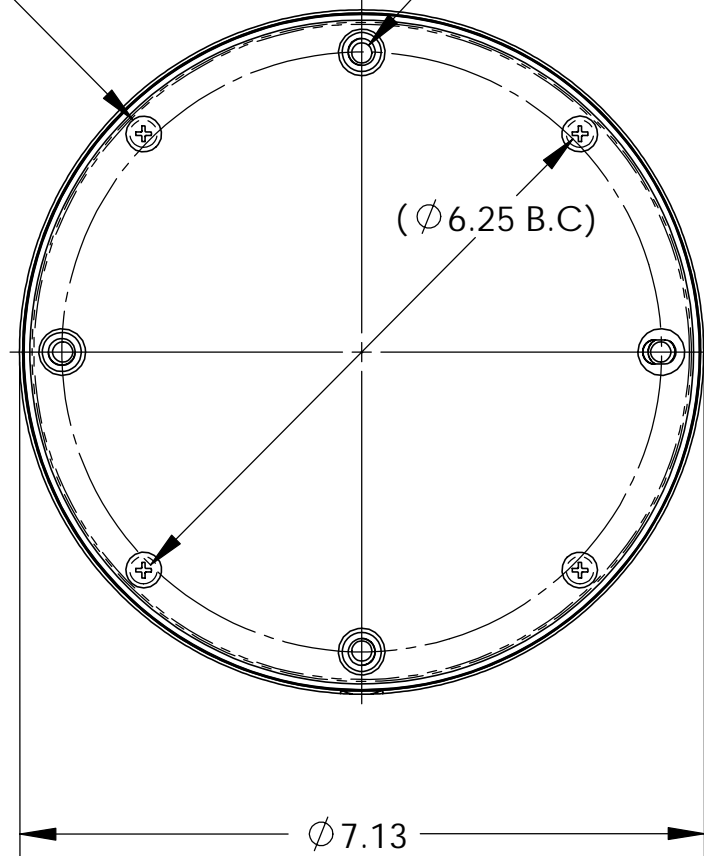

Service Part Number	Description	1010-1100-10 Qty.	1010-1100-20 Qty.	1010-1100-30 Qty.
1003-0000-10	Lens, Acrylic, Red	1	--	--
1003-0000-20	Lens, Acrylic, Amber	--	1	--
1003-0000-30	Lens, Acrylic, Clear	--	--	1
1014-0000-00	Gasket, Lens	1	1	1
1015-0000-00	Gasket, Mounting	1	1	1
9018-0013-00	Bulb, Miniature, #1156, 32cp	1	1	1
9028-0006-00	Screw, Lens, 8-32 x 7/16 PPHMS, TT	4	4	4

UNLESS OTHERWISE SPECIFIED DIMENSIONS ARE IN INCHES TOLERANCES ARE: X.XXX - ±0.005 X.XX - ±0.020 X.X - ±0.050 ANGLES - ±0.5°	CAD GENERATED DRAWING, DO NOT MANUALLY UPDATE		<b>WELDON TECHNOLOGIES, INC.</b>		
	APPROVALS	DATE			
	DRAWN	TS	7/5/06	CUSTOMER DRAWING 7" ROUND TURN SIG. (NO ARROW) STOP / DOME LAMP	
	CHECKED	ST	7/5/06		
MATERIAL	QUAL ENG				
FINISH	MFG ENG		SIZE B	PART NO. C1010-1100-00	REV. A
DO NOT SCALE DRAWING	PROJ. NO.		SCALE: 1:1	WELDON COMPUTER GRAPHICS	SHEET 1 OF 1