

8 7 6 5 4 3 2 1

THIS DRAWING AND ALL INFORMATION CONTAINED HEREIN IS THE PROPERTY OF WELDON TECHNOLOGIES, INC. AND MAY NOT BE COPIED, REPRODUCED, OR DEVIATED TO UNAUTHORIZED PERSONS WITHOUT THE EXPRESS WRITTEN CONSENT OF WELDON TECHNOLOGIES, INC. AS IT IS BEING PROVIDED SOLELY FOR THE CONVENIENCE OF THE USER AND SHALL BE RETURNED TO WELDON TECHNOLOGIES, INC UPON REQUEST.

REVISIONS					
REV.	ECN	DESCRIPTION	DATE	BY	APVD
A	R0557	PRODUCT RELEASE	10/4/04	gd	ST
B	0591	REMOVED TPA LOCK AND ADDED IT TO CABLE ASS'Y	5/17/05	gd	ST

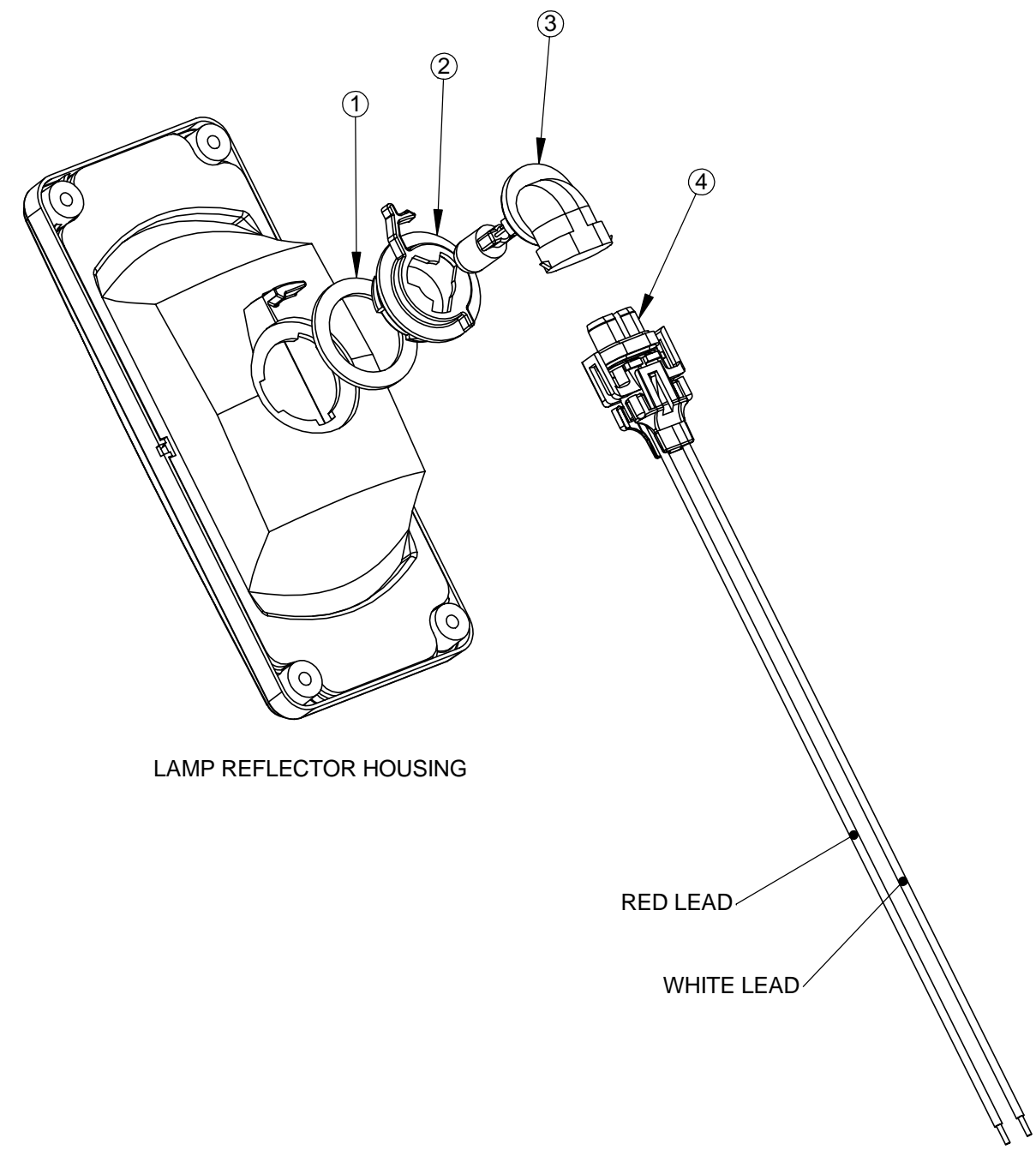

ADAPTER INSTALLATION INSTRUCTIONS:

- 1) DISCONNECT ALL POWER TO LAMPS BEFORE SERVICING.
- 2) REMOVE THE EXISTING LAMP AND SOCKET FROM THE REFLECTOR BY DEPRESSING THE LOCKING LEVER ON THE LAMP SOCKET AND ROTATING IT COUNTER-CLOCKWISE TO REMOVE IT.
- 3) CUT THE RED AND WHITE LEADS ON THE LAMP SOCKET BEING REPLACED SIX INCHES FROM THE LAMP SOCKET, AND DISCARD THE LAMP AND SOCKET.
- 4) STRIP THE ENDS OF THE LEADS TO EXPOSE ¼" OF WIRE, AND INSTALL AN INSULATED, BUTT-SPLICE TERMINAL (18-22 AWG) ON EACH LEAD.
- 5) LOCATE THE 886 LAMP, CABLE ASSEMBLY AND INSERT THE RED AND WHITE LEADS INTO THE BUTT-SPLICE TERMINALS INSTALLED IN STEP 4, AND CRIMP THEM IN PLACE. IT IS IMPORTANT TO ENSURE THAT THE COLORS ARE MATCHED BEFORE CRIMPING. (RED TO RED, WHITE TO WHITE)
- 6) PLACE A LAMP-SOCKET SEAL ON THE 886 LAMP ADAPTER.
- 7) INSTALL THE LAMP ADAPTER BY INSERTING THE ADAPTER INTO THE LAMP REFLECTOR AND TURNING IT CLOCKWISE UNTIL THE ADAPTER IS LOCKED TO THE REFLECTOR HOUSING.
- 8) LOCATE THE 886 RIGHT-ANGLE HALOGEN LAMP AND INSERT IT INTO THE PREVIOUSLY INSTALLED LAMP ADAPTER BY TURNING IT CLOCKWISE UNTIL LOCKED.
- 9) PLUG THE 886 LAMP, CABLE ASSEMBLY, INSTALLED IN STEP 5, INTO THE LAMP'S RECEPTACLE.
- 10) REVIEW STEPS 1-9, AND CHECK FOR EXPOSED WIRES, LOOSE TERMINALS, AND WIRING ERRORS. CORRECT IF NECESSARY.
- 11) RESTORE POWER AND TEST THE LAMP.

ITEM	DESCRIPTION	PART NUMBER
1	LAMP SOCKET SEAL	0K30-0509-00
2	886 LAMP ADAPTER	0K80-1671-00
3	886 RIGHT-ANGLE, HALOGEN LAMP	OE22-1357-00
4	886 LAMP, CABLE ASSEMBLY	0L40-1805-00

UNLESS OTHERWISE SPECIFIED DIMENSIONS ARE IN INCHES TOLERANCES ARE: X.XXX - ±0.005 X.XX - ±0.020 X.X - ±0.050 ANGLES - ±0.5*	CAD GENERATED DRAWING, DO NOT MANUALLY UPDATE		WELDON TECHNOLOGIES, INC.		
	APPROVALS	DATE			
	DRAWN	GD	1/13/05	886 LAMP ADAPTER ASS'Y	
	CHECKED	ST	1/14/05		
MATERIAL	QUAL ENG				
FINISH	MFG ENG		SIZE B	PART NO. C0K90-1806-00	REV B
DO NOT SCALE DRAWING	PROJ. NO.		SCALE: 1:1	WELDON COMPUTER GRAPHICS	SHEET 1 OF 1