



**STYLE 7675 SLO-CLOZ™**  
**FOR VALVES WITH A RACK AND SECTOR ACTUATOR**  
**INSTALLATION AND ADJUSTMENT INSTRUCTIONS**

This unit is designed to be installed on 2 ½", 3", or 3 ½" Akron Swing-Out™ Valves with a Rack and Sector Actuator.  
(Series 7600 or 8600 Valves)

It is not intended for installation on Akron Style 7800 Series Valves with Tork-Lok®, 8800 Series self-locking Valves or any non Akron Valve. Note: The Slo-Cloz mechanism will add approximately 2" in height to the valve. Be sure there is enough clearance to allow the unit to be installed.

Identify the type of Valve before beginning installation.

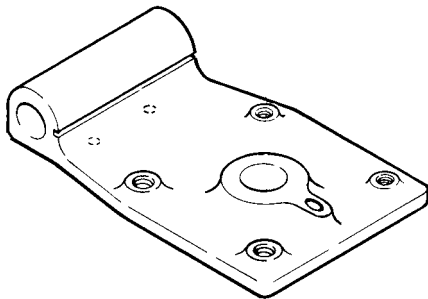

Rack & Sector Carrier Bracket

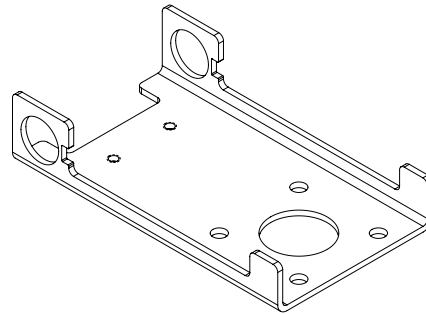

Rack & Sector Platform

**INSTALLATION FOR RACK AND SECTOR ACTUATORS WITH CARRIER BRACKET**

(This type of Actuator was manufactured prior to August 2003.)

1. Place the Valve in the ½ open position. Note the position of the Rack and Sector.
2. Remove and discard the Bolt and Washer from the Rack and Sector.
3. Place the Slo-Cloz on the Gear Sector so the 4 pins on the bottom of the mechanism fit into the 4 slots on the Gear Sector. Be sure the Lug on the Slo-Cloz mechanism fits into the slot on the Bracket. The bottom of the Slo-Cloz should fit firmly against the Bracket.

Note: It may be necessary to rotate slightly the 4 pins to get the proper fit. Placing a screwdriver shank between 2 of the pins and gently rotating them to the proper position can change the pin location.

4. Secure the Slo-Cloz using the replacement Washer and Bolt from the Kit. Tighten the Bolt with a ¾" wrench.
5. Operate the Slo-Cloz to be sure the Valve will fully open and close.
6. If adjustments are necessary, see the Adjustment Instructions.

## **INSTALLATION FOR RACK AND SECTOR ACTUATORS WITH PLATFORM**

(This type of Actuator was manufactured after August 2003.)

1. Place the Valve in the  $\frac{1}{2}$  open position. Note the position of the Rack and Sector.
2. Remove and discard the Bolt and Washer from the Rack and Sector.
3. Remove and discard the 2 Bolts opposite the Rack that secure the Platform to the Valve Body.
4. Place the Bracket on the Platform and using the holes referenced in Step #3, attach the Bracket with 2 longer Bolts from the Kit.
5. Place the Slo-Cloz on the Gear Sector so the 4 pins on the bottom of the mechanism fit into the 4 slots on the Gear Sector. Be sure the Lug on the mechanism fits into the notch of the Bracket attached in Step #4. The bottom of the Slo-Cloz should fit firmly against the Platform.  

Note: It may be necessary to rotate slightly the 4 pins to get the proper fit. Placing a screwdriver shank between two of the pins and gently rotating them to the proper position can change the pin location.
6. Secure the Slo-Cloz using the replacement Washer and Bolt from the Kit. Tighten the Bolt with a  $\frac{3}{4}$ " wrench.
7. Operate the Slo-Cloz to be sure the Valve will fully open and close.
8. The Valve should not travel from full open to full close in less than 3 seconds. If adjustments are necessary, see Adjustment Instructions.

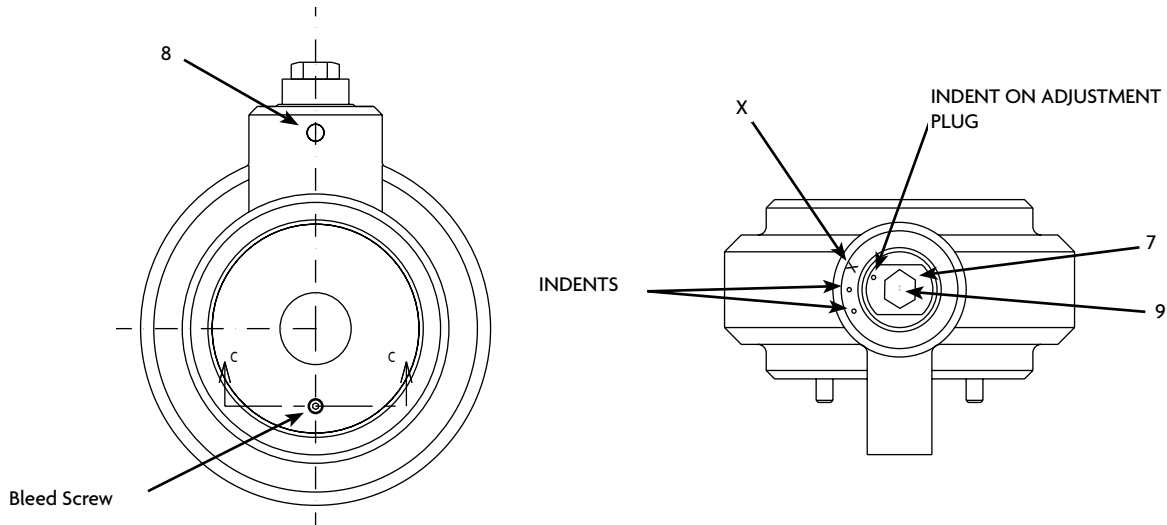

### ADJUSTMENT INSTRUCTIONS

The Slo-Cloz device is designed to retard the speed on manual valves. Each Slo-Cloz is factory set to go from full open to full close in no less than 5 seconds and no more than 12 seconds. It is not recommended the retardation capability be increased in the field.

Due to various applications such as valve size, handle type and length, linkage, water pressure and other factors, it may be necessary to reduce the retardation.

The retarding capability of the unit is determined by the position of the Adjustment Plug (#7) located on the boss extending from the body.

Note the “indents” on the edge of the face of the Adjustment Plug and the “X” stamped on the Body. These 2 marks should be in line. This marks the maximum setting on the unit. To reduce the retardation, the Adjustment Plug can be turned counterclockwise. The further the Adjustment Plug is turned the less the retardation. The 2 “indents” to the left of the “X” are for reference. It is not recommended the device be retarded past these marks.

### ADJUSTMENT PROCEDURE

1. Be sure the Slo-Cloz is properly installed on the Valve.
2. Loosen the Set Screw (#8).
3. To decrease the retarding force, turn the Adjustment Plug counterclockwise.
4. Once the desired setting is achieved, retighten the Set Screw.

Note: Do not use a wrench on the Hex Plug (#9) while adjusting the Adjustment Plug.

### MAINTENANCE

Under normal conditions, the Slo-Cloz device does not require maintenance. If maintenance is required, contact Akron Brass Customer Service.



PHONE: 330.264.5678 or 800.228.1161 | FAX: 330.264.2944 or 800.531.7335 | akronbrass.com

REVISED: 6/11

WARRANTY AND DISCLAIMER: We warrant Akron Brass products for a period of five (5) years after purchase against defects in materials or workmanship. Akron Brass will repair or replace product which fails to satisfy this warranty. Repair or replacement shall be at the discretion of Akron Brass. Products must be promptly returned to Akron Brass for warranty service.

We will not be responsible for: wear and tear; any improper installation, use, maintenance or storage; negligence of the owner or user; repair or modification after delivery; damage; failure to follow our instructions or recommendations; or anything else beyond our control. WE MAKE NO WARRANTIES, EXPRESS OR IMPLIED, OTHER THAN THOSE INCLUDED IN THIS WARRANTY STATEMENT, AND WE DISCLAIM ANY IMPLIED WARRANTY OF MERCHANTABILITY OR FITNESS FOR ANY PARTICULAR PURPOSE. Further, we will not be responsible for any consequential, incidental or indirect damages (including, but not limited to, any loss of profits) from any cause whatsoever. No person has authority to change this warranty.

© Akron Brass Company, 2011 All rights reserved. No portion of this can be reproduced without the express written consent of Akron Brass Company.