

TECHNICAL SERVICE PARTS

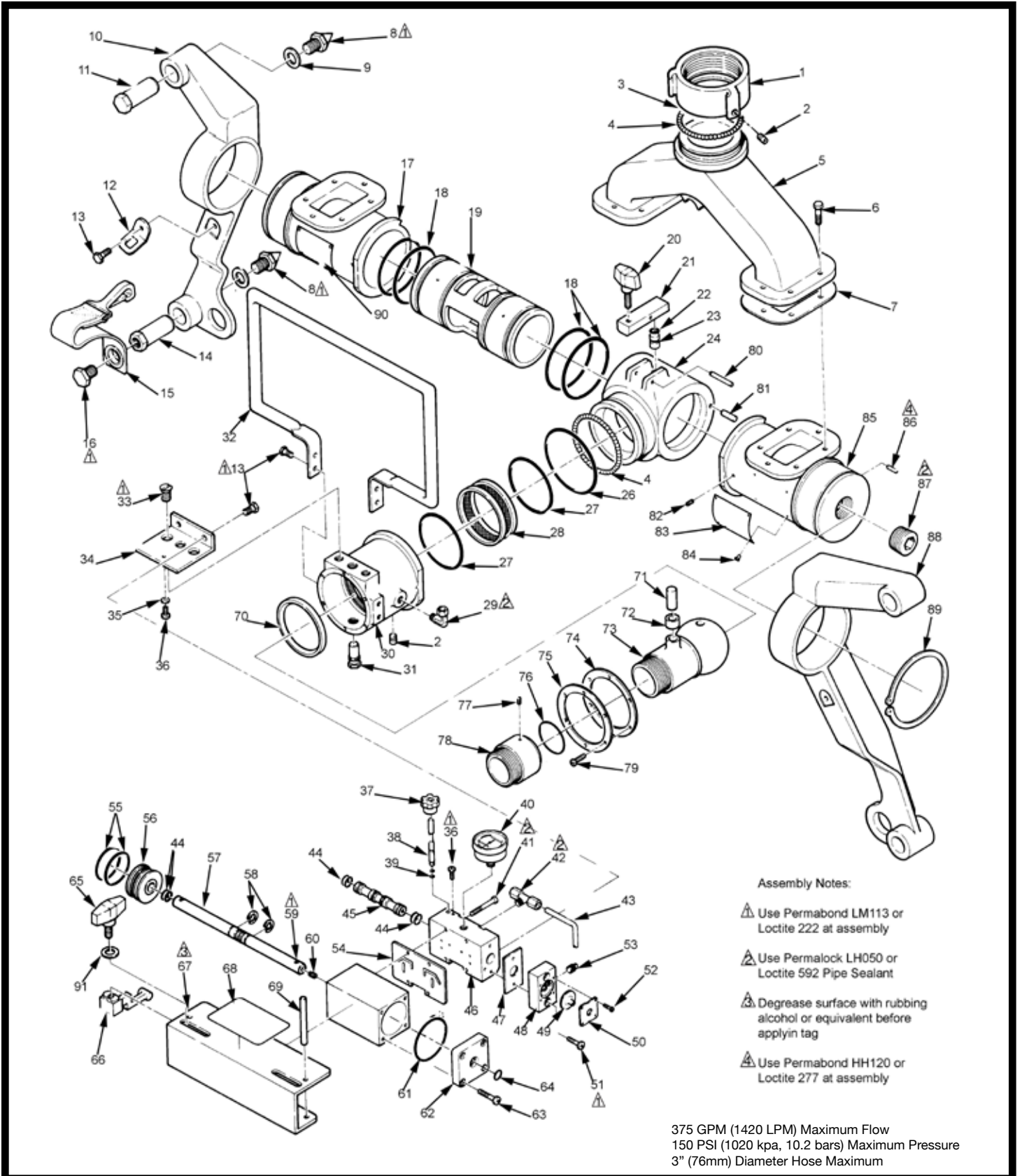

Assembly Notes:

▲ Use PermaBond LM113 or Loctite 222 at assembly

▲ Use PermaLock LH050 or Loctite 592 Pipe Sealant

▲ Degrease surface with rubbing alcohol or equivalent before applyin tag

▲ Use PermaBond HH120 or Loctite 277 at assembly

375 GPM (1420 LPM) Maximum Flow
150 PSI (1020 kpa, 10.2 bars) Maximum Pressure
3" (76mm) Diameter Hose Maximum



**STYLE 911
OZZIE™
TECHNICAL SERVICE PARTS LIST**

| ITEM NO. | DESCRIPTION | PART NUMBER | QTY |
|----------|--------------------------------|-------------|-----|
| 1 | 2-1/2" NH Inlet† | 101420 | 1 |
| 1 | 2-1/2" BSP Inlet (Not Shown) | 101422 | 1 |
| 1 | 2-1/2" BIM Inlet (Not Shown) | 0326-0005 | 1 |
| 1 | 75mm Storz Inlet** (Not Shown) | 104393 | 1 |
| 2 | Swivel Plug | 7-42-023 | 2 |
| 3# | 2-1/2" NH Gasket | 7-17-043 | 1 |
| 3 | 2-1/2" BSP Gasket (Not Shown) | 7-14-020 | 1 |
| 3 | 75mm Storz Seal (Not Shown) | 7-69-331 | 1 |
| 4 | Ball Bearings | ‡ | 75 |
| 5 | Inlet Wye | 101903 | 1 |
| 6 | Hex Head Cap Screw | 7-61-077 | 12 |
| 7 | Manifold Gasket | 7-17-040 | 2 |
| 8 | Ground Spike | 7-69-666 | 4 |
| 9 | Flat Steel Washer | 7-84-068 | 4 |
| 10 | Right Leg | 101902 | 1 |
| 11 | Ground Sleeve | 7-69-302 | 2 |
| 12 | Strap Clip | 7-07-224 | 2 |
| 13 | Hex Head Cap Screw | 7-61-050 | 8 |
| 14 | Safety Sleeve | 7-69-303 | 2 |
| 15 | Strap Assembly | 7-69-379 | 2 |
| 16 | Hex Head Cap Screw | 7-61-065 | 2 |
| 17 | Manifold Right | 109210 | 1 |
| 18 | O-Ring | 7-57-065 | 4 |
| 19 | Waterway Tube | 109273 | 1 |
| 20 | Elevation Knob | 7-27-032 | 1 |
| 21 | Rocker Arm | 101895 | 1 |
| 22 | O-Ring | 7-57-005 | 1 |
| 23 | Plunger | 7-44-284 | 1 |
| 24 | Vertical Turret | 101906 | 1 |
| 26 | O-Ring | 7-57-149 | 1 |
| 27 | O-Ring | 7-57-221 | 2 |
| 28 | Screen | 7-69-398 | 1 |
| 29 | Elbow Fitting | 7-13-075 | 2 |
| 30 | Horizontal Turret | 101907 | 1 |
| 33 | Flat Head Screw | 7-67-068 | 2 |
| 34 | Motor Bracket | 7-04-256 | 1 |

| ITEM NO. | DESCRIPTION | PART NUMBER | QTY |
|----------|-----------------------|-------------|-----|
| 35 | Washer | 7-84-072 | 1 |
| 36 | Button Head Screw | 7-65-143 | 2 |
| 37 | Brake Knob | 7-27-031 | 1 |
| 38 | Valve Stem | 7-69-380 | 1 |
| 39 | O-Ring | 7-57-262 | 2 |
| 40 | Pressure Gauge (PSI) | 7-18-184 | 1 |
| 40 | Pressure Gauge (Bar) | 7-18-134 | 1 |
| 41 | Socket Head Cap Screw | 7-67-100 | 4 |
| 42 | Brass Tee Fitting | 7-12-271 | 1 |
| 43 | Bleed Tube | 7-72-130 | 2 |
| 44# | O-Ring | 7-57-260 | 6 |
| 45 | Valve Spool | 7-68-228 | 1 |
| 46 | Valve Block | 7-03-366 | 1 |
| 47# | Valve Cap Gasket | 7-14-193 | 2 |
| 48 | Valve Cap | 101900 | 2 |
| 49 | Diaphragm Valve | 7-79-053 | 2 |
| 50 | Retainer | 7-58-168 | 2 |
| 51 | Socket Head Cap Screw | 7-67-086 | 4 |
| 52 | Pan Head Screw | 7-63-012 | 8 |
| 53 | Exhaust Plug | 7-44-283 | 2 |
| 54 | Block Gasket | 7-17-039 | 1 |
| 55# | O-Ring | 7-57-259 | 2 |
| 56 | Piston | 7-44-285 | 1 |
| 57 | Cylinder Rod | 7-49-025 | 1 |
| 58 | Retaining Ring | 7-58-192 | 2 |
| 59 | Socket Head Set Screw | 7-65-071 | 2 |
| 60 | Cylinder Block | 101899 | 1 |
| 61 | O-Ring | 7-57-271 | 2 |
| 62 | Cylinder Cap | 7-07-225 | 2 |
| 63 | Button Head Screw | 7-66-009 | 8 |
| 64# | O-Ring | 7-57-258 | 2 |
| 65 | Limit Knob | 7-27-030 | 2 |
| 66 | Limit Arm | 7-02-049 | 2 |
| 67 | Drive Cover | 7-07-223 | 1 |
| 68 | Name Plate | 7-73-204 | 1 |
| 69 | Locking Pin | 7-41-053 | 2 |

* Note: BIM Inlet requires BSP Gasket (PN-7-14-020) and BSP Inlet (PN 101422)

** Storz Inlet includes items 92-96 (not shown)

† For other threads order by description and thread size (ODM and TPI) or by Akron Thread Code.

‡ Packet of 50 Ball Bearings - P/N 109041

Parts included in Field Service Kit # 9191



**STYLE 911
OZZIE™
TECHNICAL SERVICE PARTS LIST**

| ITEM NO. | DESCRIPTION | PART NUMBER | QTY |
|----------|------------------------------------|-------------|-----|
| 70# | Ball Seal | 7-69-378 | 1 |
| 71 | Roll Pin | 7-44-287 | 1 |
| 72 | Roller | 7-58-169 | 1 |
| 73 | Outlet | 101904 | 1 |
| 74 | Ball Cover | 7-07-227 | 1 |
| 75 | Ball Cover Retainer | 7-07-228 | 1 |
| 76 | O-Ring | 7-57-125 | 1 |
| 77 | Allen Head Screw | 7-65-025 | 1 |
| 78 | 1-1/2" NH Discharge† | 101896 | 1 |
| 78 | 1-1/2" NPSH Discharge† (Not Shown) | 101897 | 1 |
| 78 | 1-1/2" BSP Discharge† (Not Shown) | 101898 | 1 |
| 79 | Pan Head Screw | 7-67-069 | 6 |
| 80 | Roll Pin | 7-44-060 | 1 |
| 81 | Roll Pin | 7-44-067 | 2 |
| 82 | Socket Head Set Screw | 7-65-070 | 6 |
| 83 | Identification Tag | 7-73-203 | 1 |
| 84 | Copper Nail Grip | 7-36-045 | 4 |
| 85 | Manifold Left | 109094 | 1 |
| 86 | Roll Pin | 7-44-069 | 2 |
| 87 | Pipe Plug | 7-44-286 | 2 |
| 88 | Left Leg | 101901 | 1 |
| 89 | Retaining Ring | 7-58-068 | 2 |
| 90 | Warning Tag (English) | 7-73-197 | 1 |
| 90 | Warning Tag (French) | 7-73-208 | 1 |
| 90 | Warning Tag (German) | 7-73-207 | 1 |
| 90 | Warning Tag (Spanish) | 7-73-209 | 1 |
| 91 | Washer | 7-84-075 | 2 |
| 92 | Storz Gasket** (Not Shown) | 7-14-179 | 1 |
| 93 | Storz Adapter** (Not Shown) | 104401 | 1 |
| 94 | Storz O-Ring** (Not Shown) | 7-57-045 | 1 |
| 95 | Storz Housing** (Not Shown) | 104409 | 1 |
| 96 | Storz O-Ring** (Not Shown) | 7-57-087 | 1 |
| 97 | Oscillation Tag On/Off (Not Shown) | 7-73-292 | 1 |
| 98 | Caution Tag (Not Shown) | 7-73-291 | 1 |

* Note: BIM Inlet requires BSP Gasket (PN-7-14-020) and BSP Inlet (PN 101422)

** Storz Inlet includes items 92-96 (not shown)

† For other threads order by description and thread size (ODM and TPI) or by Akron Thread Code.

‡ Packet of 50 Ball Bearings - P/N 109041

Parts included in Field Service Kit # 9191



PHONE: 330.264.5678 or 800.228.1161 | FAX: 330.264.2944 or 800.531.7335 | www.akronbrass.com

REVISED: 8/08

WARRANTY AND DISCLAIMER: We warrant Akron Brass products for a period of five (5) years after purchase against defects in materials or workmanship. Akron Brass will repair or replace product which fails to satisfy this warranty. Repair or replacement shall be at the discretion of Akron Brass. Products must be promptly returned to Akron Brass for warranty service.

We will not be responsible for: wear and tear; any improper installation, use, maintenance or storage; negligence of the owner or user; repair or modification after delivery; damage; failure to follow our instructions or recommendations; or anything else beyond our control. WE MAKE NO WARRANTIES, EXPRESS OR IMPLIED, OTHER THAN THOSE INCLUDED IN THIS WARRANTY STATEMENT, AND WE DISCLAIM ANY IMPLIED WARRANTY OF MERCHANTABILITY OR FITNESS FOR ANY PARTICULAR PURPOSE. Further, we will not be responsible for any consequential, incidental or indirect damages (including, but not limited to, any loss of profits) from any cause whatsoever. No person has authority to change this warranty.

© Premier Farnell Corporation. 2000 All rights reserved. No portion of this can be reproduced without the express written consent of Premier Farnell Corporation.

A Premier Farnell Company