

NOTE: This product is currently no longer in production. For service and repair, please contact Akron's Customer Service at 800.228.1161 or 330.264.5678.

**STYLE 2580 and 2581
Pyrolite® Wyes**

TECHNICAL SERVICE PARTS LIST

OPERATING INSTRUCTIONS

- Maximum operating pressure 250 PSI (14 Bar)
- Open and close slowly

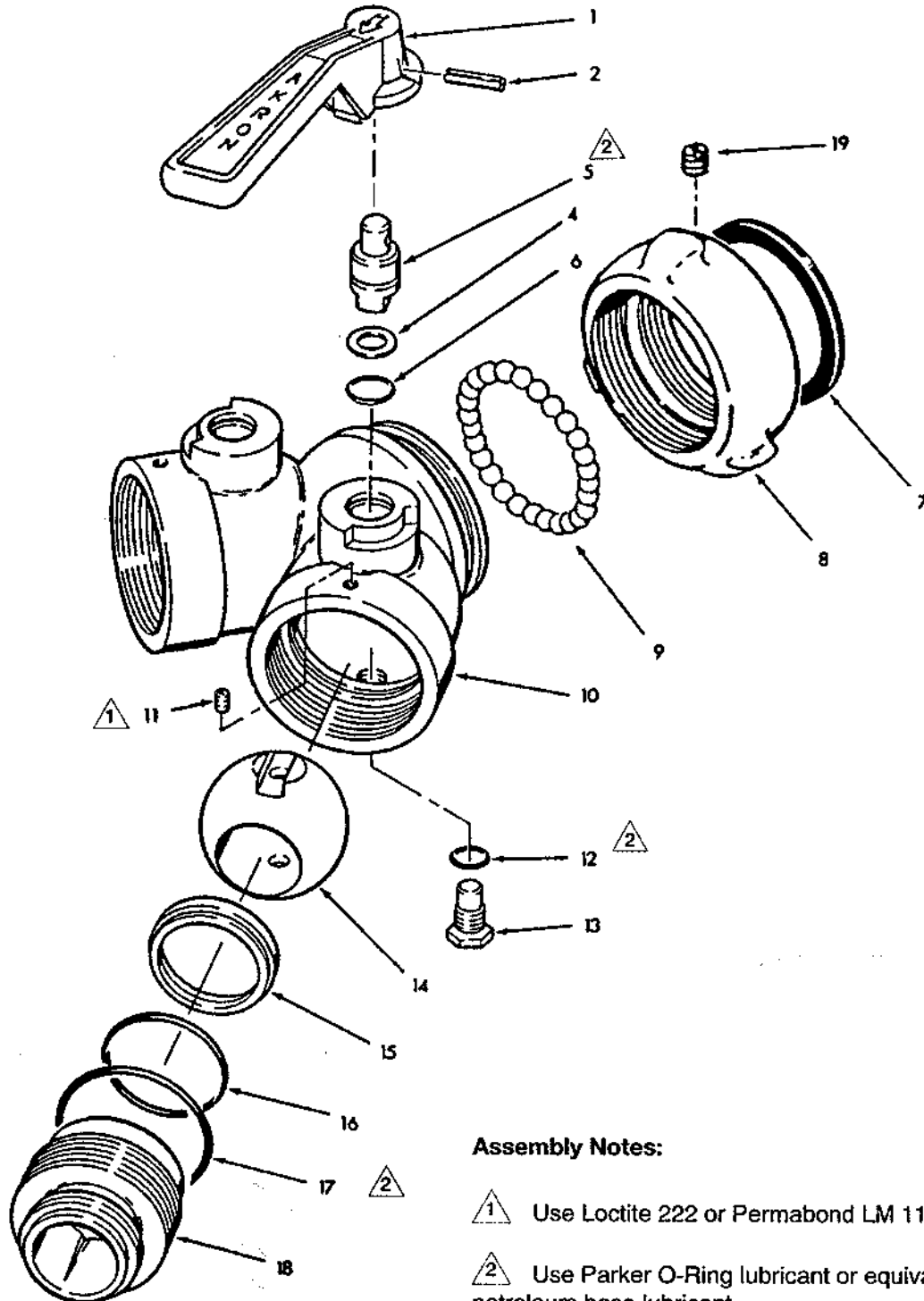

Assembly Notes:

- ① Use Loctite 222 or PermaBond LM 113
- ② Use Parker O-Ring lubricant or equivalent petroleum base lubricant

TECHNICAL SERVICE PARTS LIST

ITEM NO.	DESCRIPTION	PART NUMBER	QUANTITY	
			2580	2581
1	Handle	7-21-317	2	2
2	Roll Pin	7-44-060	2	2
4	Thrust Ring	7-56-120	2	2
5†††	Trunnion	117607	2	2
6	O-Ring	7-57-174	2	2
7**	Swivel Gasket-1 1/2"	7-17-042	1	
7**	Swivel Gasket - 2 1/2"	7-17-043		1
8††	Swivel—1 1/2" (NH)†	115424	1	
8††	Swivel—2 1/2" (NH)†	101420		1
9	Ball Bearings	*	25	38
10	Body	117610	1	
10	Body	117608		1
11	Set Screw	7-65-002	2	2
12**	O-Ring	7-57-180	2	2
13	Threaded Trunnion	102094	2	2
14**	Ball	7-03-151	2	2
15**	Seat	7-69-243	2	2
16**	O-Ring	7-57-197	2	2
17	O-Ring	7-57-021	2	2
18	Male Adapter — 1 1/2" NH†	104194	2	2
18	Male Adapter — 1 1/2" NPSH†	104195	2	2
18	Male Adapter — 1"NH†	115177	2	
19	Swivel Plug	7-42-023	1	1

*Packet of 50 Locking Balls - P/N 109041

** Parts included in Field Service Kit No. 9153.

† For other threads order by description and thread size (ODM and TPI) or by Akron Thread Code.

†† If the swivel is attached by a piston ring, the unit must be returned to the factory to change the body or swivel.

††† On units manufactured prior to October 2000 the Trunnion (Item 5) is removed through the top of the body (Item 10). If this part of the Wye is being repaired, the unit should be returned to the factory.