

TECHNICAL SERVICE PARTS LIST

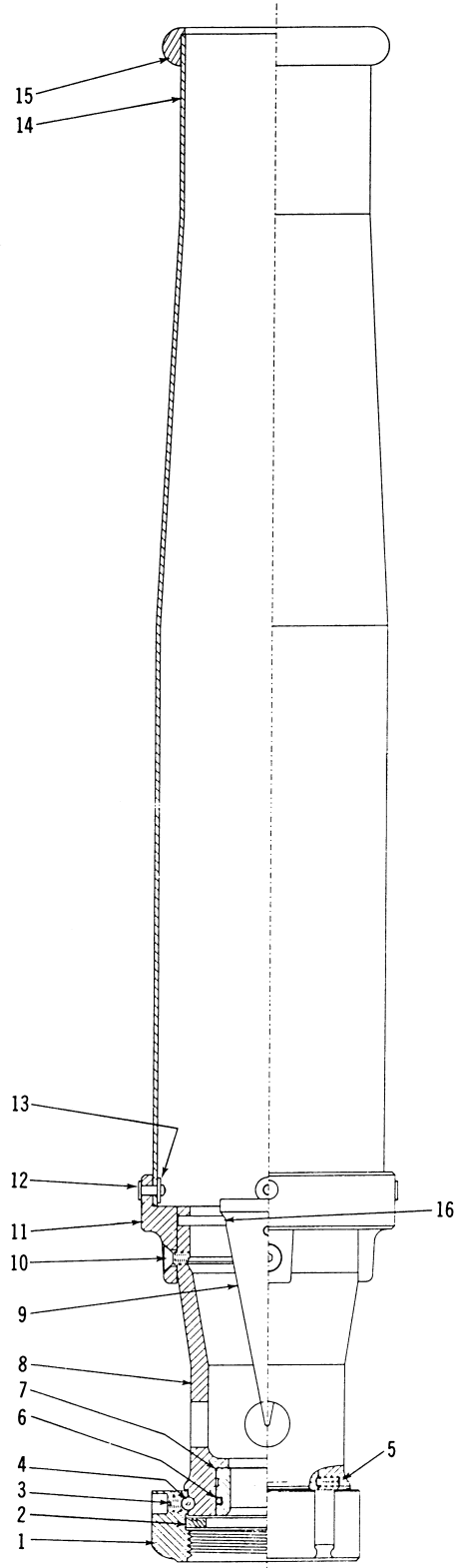

ITEM NO.	DESCRIPTION	PART NUMBER	QUANTITY
1	Swivel - 2 1/2"NH*	101420	1
2	Gasket	7-17-043	1
3	Swivel Plug	7-42-023	1
4	Ball Bearings	**	38
5	Socket Head Screw	7-67-088	1
6	O-Ring	7-57-032	1
7	250 GPM Orifice	104674	1
7	500 GPM Orifice	104675	1
8	Inlet Body	104672	1
9	Baffle	7-04-304	1
10	Flat Head Screw	7-65-101	4
11	Tube Ring	104677	1
12	Rivet	7-54-053	4
13	Washer	7-84-098	4
14	Expansion Tube	104678	1
15	Bumper	104673	1
16	Pin	7-44-306	2

* For other threads order by description & Thread size (ODM & TPI) or by Akron Thread Code.

** Packet of 50 Ball Bearings - P/N 109041

Operating Instructions

1. Check GPM setting by looking in swivel end.
250 GPM orifice is .98" marked 250 GPM/950 LPM.
500 GPM orifice is 1.420" marked 500 GPM/1900 LPM.
2. Check that the threads on the swivel match the hose connection.
3. After use with foam and/or saltwater, flush with fresh water.
4. Remove any dirt or grime after use.
5. Operate foam tube at 100 PSI pressure.